

User Manual

CP-DRP1201SW

CUCKOO

CUCKOO Electric Water purifier
쿠쿠 냉온정수기

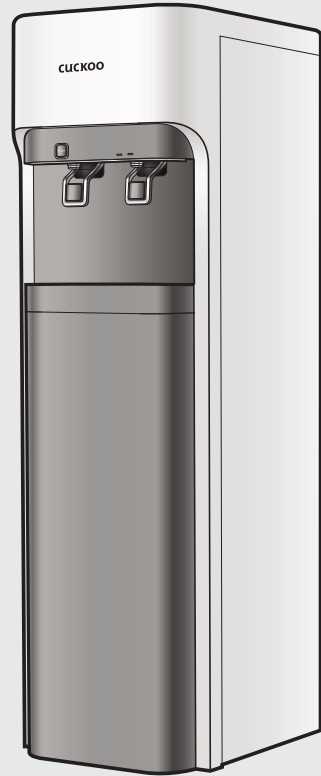

CUCKOO



To our customers!

Thank you for choosing Cuckoo Water Purifier.

Please keep this User Manual (including the Warranty) for your reference. This manual will guide you when you have any questions or when the product does not work properly.

Merits of Cuckoo Water Purifier

① 4-Step Filtration System

The 4-step filtration system of Cuckoo Water Purifier makes clean and healthy water.

① Stainless Steel Water Tank

Using a stainless steel water tank improves the water quality and cleanliness.

① Reverse Osmosis Filtration system

Clean water is provided by applying a reverse osmosis membrane.

① Operation Status Indicator

For added convenience, you are able to check the operation status through the operation status indicator.

① Child Lock button

The child lock button prevents children or others from the burn hazards associated with hot water.

① Individual Power Switches for Hot and Cold Water

Energy efficient design with individual "hot" & "cold" power switches.

CONTENTS

Before Use	●	Warnings for Safe Use	4~7
		Cautions for Safe Use	8
		Name of Parts/Components Information	9
How to Use	●	Filtration Circuit/ Water Filtration System	10
		Details to Check before Installation	11
		How To Install the Product	12~13
		Details To Check before Use	14~15
		How To Use	15~16
		How To Clean the Cold Water Tank	17~19
		How To Clean Tray	20
		How To Replace the Filter	21~23
		Expected Filter Replacement Cycle /	24
		Recommendations / Filter Arrangement	
		How to install the Overturning prevention wire	25
Before Asking for Support	●	Please check before asking for support	26~27
Service Guide	●	Product Specifications	28



Warnings for Safe Use

- Please comply with the 'Warnings for Safe Use' as they are provided to ensure safe and proper use of the product and prevent accidents and dangerous situations.
- The 'Warnings for Safe Use' section is divided into 'Warning' and 'Caution' which are defined as follows.

Warning

Potentially dangerous situation that can cause serious injuries or death if not avoided.

Caution

Potentially dangerous situation that can cause minor injuries if not avoided.



- This symbol is to remind you to be cautious about a potentially dangerous situation under special circumstances.
- Please read the details carefully and follow the instructions to avoid dangerous situations.



- This symbol is used to indicate actions that are prohibited.



- This symbol is used to indicate 'instructed' actions.

About Power Supply

Warning

Do not

Plug the power plug into a 120V outlet with at least a rating of 10A and power surge protection. Do not plug multiple products into the same power outlet or extension cord simultaneously.

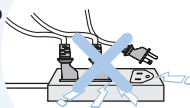

- When multiple products are plugged into the same power outlet or if the product is plugged into an inappropriate power input, it may cause heating, fire and electric shock. Please check the condition of the power outlet frequently.
- If there is a foreign substance or water on the power plug, please wipe it clean before plugging it into the socket.
- Use an extension cord of 10 A or higher.

Stop the use and contact Customer Service when the power cord or plug is damaged or the power outlet is loose.



- If the sheath of the power cord is peeled off or bent due to negligence, it may cause fire or electric shock. Please check the state of the power cord, plug and outlet frequently.
- To prevent dangerous situations due to the damage of the power cord or plug, please contact the manufacturer, distributor or Cuckoo website.
- We strongly recommend that the damaged parts be repaired or replaced from the Cuckoo website.
- This may cause electric shock or fire due to a short circuit.

Do not bend, tie or pull the power cord by force.

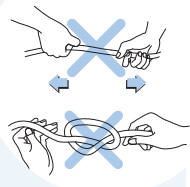

- This may cause electric shock or fire due to a short circuit. Please check the state of the power cord frequently.

Wipe off any foreign substance on the power plug with a dry cloth.



- This may cause electric shock or fire. Please check the state of the power plug frequently.

Warnings for Safe Use



About Power Supply



Do not pull the power cord when unplugging the product.

- Force applied to the power cord may cause electric shock or fire. Please check the state of the power cord and plug frequently.



Use 120V power input only.

- This may cause electric shock or fire.
- The product will not operate properly.
- Please check the state of the power cord and plug frequently.

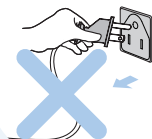

In case of water leak or cleaning, please unplug the power plug first.

- This may cause electric shock or malfunction. Please check the state of the power cord and plug frequently.

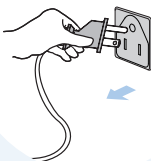

Do not plug or unplug the power plug with wet hands.

- Unplugging the power plug with wet hands may cause electric shock.
- Pulling the power cord by force can damage the cord and may cause a short circuit or electric shock. Please check the state of the power cord and plug frequently.



Make sure the power cord is not under a heavy object or near sharp objects. Please ensure that it is not damaged by your pet.

- If the power cord is damaged, it may cause electric shock or fire. Please check the state of the power cord frequently.



If the power supply area is wet, unplug the product and let it dry completely before use.

- This may cause electric shock or fire. Please check the state of the power cord and plug frequently.

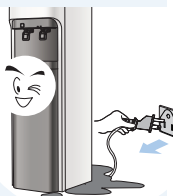

Please turn off the product by pressing the power button. Also, unplug the product before inspection, repair or replacement of its components.

- This may cause electric shock or breakdown. Please check the state of the power cord frequently.

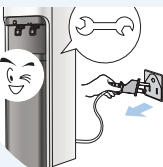

When you do not use the product for a long time, close the tap water supply valve, drain the remaining water from the tank by pressing the "Out Flow" button and unplug the power plug.

- This may cause electric shock or fire. Please check the state of the power cord and plug frequently.
- Before using the product again, please refer to the 'Details to Check before Use.'





Warnings for Safe Use

Installation Issues

 **Warning**

 **Do not**

Do not place the product in a place with high moisture or dust.

- This may cause electric shock or fire.



Do not place it in an area with potential for gas leak or near a heating product.

- This may cause fire or explosion.

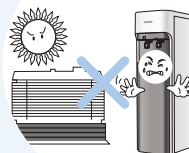

Do not install the product near the bathroom.

Do not place it in a bumpy or inclined area. Do not place it on a rug, cushion or laminated floor.

- This may cause malfunction, unwanted noise or injury. Please check the state of the product frequently.

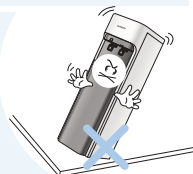

Use tap water as the supplying water, and install the Tap water supply valve to the "Cold" water pipe.

- Do not use underground water or anything other than tap water.
- The replacement cycle of the filter will vary according to the region and the amount of water use.
- Connecting the water supply valve to the hot water pipe may cause damage to the filter or malfunction of the product.



Avoid direct sunlight and high temperature.

- This may cause color changes.
- Please check the state of the power cord frequently.

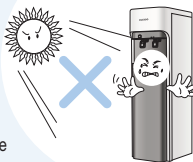

Do not place the product in an area that falls below 0°C.

- This may cause the filter or the internal components to freeze, causing malfunction.

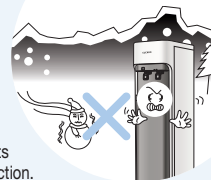

Make sure the distance of the tap water supply tube connecting the product to the tap water supply valve is less than 5m.

- This may cause reduced performance.

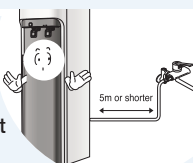

If the surrounding temperature falls below 0°C, it may cause the water inside the filter and / or tubing to freeze, causing malfunction of the product. Thus, please ensure that the surrounding temperature does not fall below 0°C.

- In case that tap water is frozen and cannot be supplied to the product because of lower than freezing temperature of the surroundings, please turn off the hot water power for safety.

Warnings for Safe Use



Warning

Do not

Do not place any heating product, such as a microwave, electric oven or toaster, or flammable materials such as candles or gas containers, on top of the product.

- There is risk of fire, electric shock or accidents.

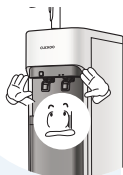

Do not place any chemicals, water bottles or small metal materials on top of the product.

- This may cause fire or damage the product when it enters into the product.



Do not pull the power cord or the connecting tube or grab the water faucet when moving the product.

- This may cause damage to the product. Please check the state of the power cord frequently.

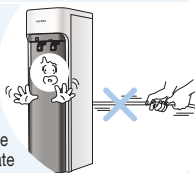

Do not disassemble or modify the product.

- This may cause fire or electric shock.
- Do not allow anyone other than a professional to disassemble or repair the product.
- Contact Cuckoo website or certified distributor for repair, AS service and information.



In order to prevent accidents and injury, make sure that your hands or other parts of the body do not touch the condenser (radiator) at the back of the product, as it gets hot during use.

- This may lead to burns or accidents.

Do not let children or anyone to control the control panel too much.

- It may cause malfunction or accidents.

Do not turn on the "Cold" & "Hot" buttons when the tank is empty.

- This may cause malfunction of the product
- First open the tap water valve to check if the water is cut off. Do not press the "Cold" & "Hot" buttons when the tank is empty. Fill the tank fully with water before pressing "Cold" & "Hot" buttons.
- If the "Hot" button is pressed when the tank is empty, the safety product will be turned on automatically to prevent the heater from running. This will cause lukewarm water to be extracted. Please contact Cuckoo website or certified distributor .

Warning

Instruction

If you smell burning or see smoke from the product, unplug the product immediately and close the tap water supply valve. Then, contact Cuckoo website or certified distributor immediately.

- This may cause electric shock.

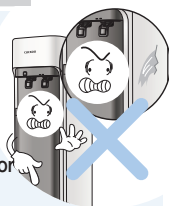

If you smell burning or see smoke from the product, unplug the product immediately and close the tap water supply valve.

After that please contact Cuckoo website or certified distributor.

- This may cause fire.

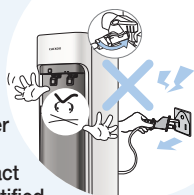

Please be cautious when using hot water.

- Make sure you do not come into direct contact with the hot water as it is extremely hot with risk of burn. Make sure seniors and children take special precautions.

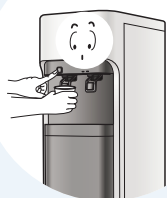



Cautions for Safe Use

⚠ Cautions

! Instruction

Make sure tank cover inside the product and the lid cover of the product are completely closed before use.

- This may allow foreign substances to enter.

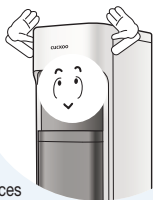

Replace the filter according to the replacement cycle.

- This may reduce the purification function or cause bad odor.
- Please refer to Page 23 for the filter replacement cycle.



After a long discontinued use, drain out water completely from the tank, and fill it with water and drain it out again before use.

- Approximately 6.8L of water will be drained from the cold water tank.
- Approximately 2.5L of water (Stand Type) will be drained from the hot water tank.
(Approximately 6L (Stand Type) of water will be drained when hot water is drained before cold water. Drain cold water before draining hot water.)



Please use only genuine Cuckoo Filter.

- Use of any filter other than a genuine Cuckoo filter may cause a decrease in water filtration performance, an abnormal taste of water, water leak, or a malfunction.

⚠ Cautions

! Prohibited

Do not clean the product using benzene or thinner.

- This may damage the product.

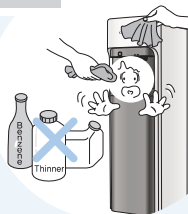

Do not move the product during operation.

- Do not shake or move the product when the power is on. The tube could be disconnected, causing product malfunction or water leak.



Do not disconnect the tube at the back of the product during the operation.

- This will lead to water leak, causing product malfunction.

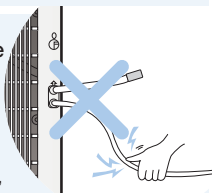

Do not use the purified water for a fish tank, an aquarium etc.

- The purified water may not be suitable for fish causing to death.

Name of Parts / Components Information



Name of Parts

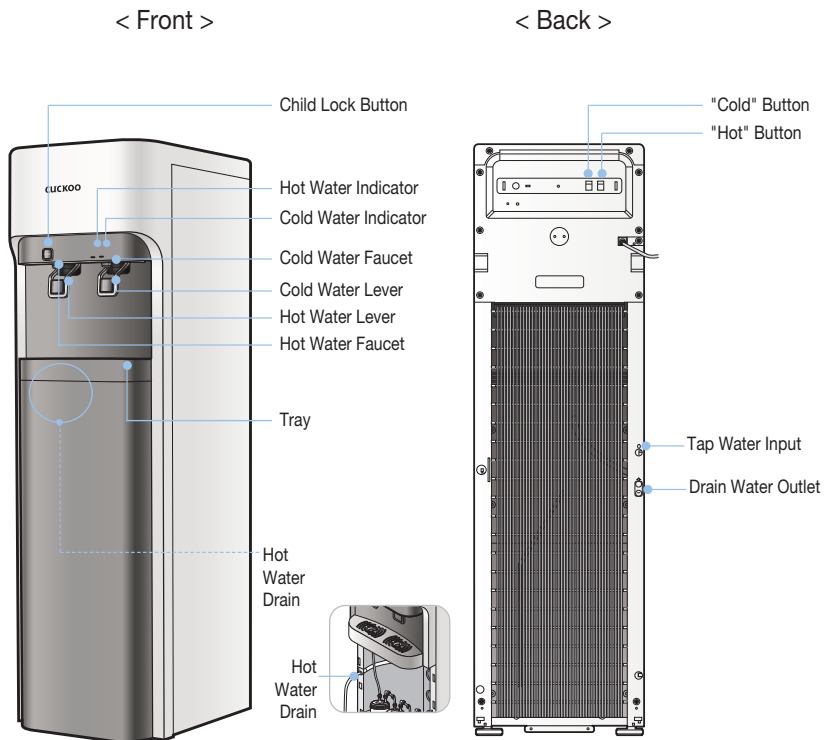

Components Information



User Manual

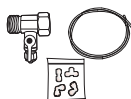

Installation Kit



Filtration Circuit / Water Filtration System

Filtration Circuit

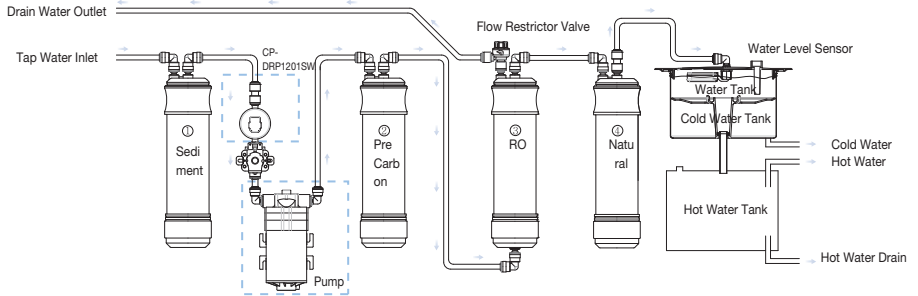

Filtration System

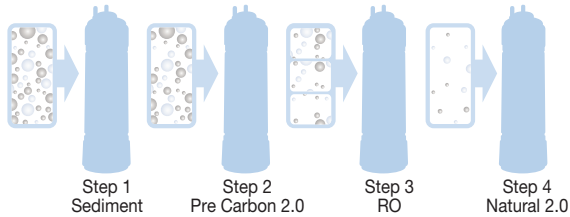

Steps	Filter Name	Filter Function
Step 1	Sediment	Removes rust sediments and floating matters.
Step 2	Pre Carbon 2.0	Removes residual chlorine and organic materials.
Step 3	RO	Remove pollutants such as heavy metals, microorganisms, organic matter and ionic substances.
Step 4	Natural 2.0	Contains anti-bacterial properties and removes smell of gases and organic materials.

※ If Cuckoo Filter (genuine) is not used or if the filter is used for a prolonged period, its performance could decrease.

- ▶ Uses of Drained Water
 - Use it while cleaning the cloths, house & toilets.
 - Never use it for Drinking & cooking purpose.

Details to Check before Installation



Details to Check before Installation

⚠ Cautions when Installing the Product

- 1 Do not place the product in direct sunlight or near a heating product.**
 - ▶ This may cause color changes or fire.
- 2 Allow installation space.**
 - ▶ To allow convenient replacement of the filters, make sure the product is placed 20cm away from the wall and that the distance of the water supply hose connecting the product to the water supply valve is less than 5m.
- 3 Avoid areas with high moisture/humidity, dust or water splash.**
 - ▶ This may cause a malfunction.
- 4 Avoid areas that are uneven, inclined or not solid.**
 - ▶ This may cause fire or a damage to the product.
- 5 Avoid areas where the temperature falls below 0 °C.**
 - ▶ This product is for indoor use. If the surrounding temperature falls below 0°C, it may cause the filters and/or the internal components to freeze, causing breakdown of the product.

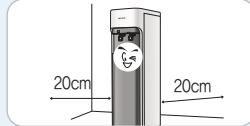
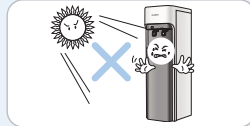

⚠ Cautions on Moving the Product

- 1 Please be careful when moving the product.**
 - ▶ Do not tilt the product at an angle over 45° .
Wait at least 30 minutes before plugging the power cord after moving the product.



⚠ Cautions on Connecting the Tube

- 1 Connect the tube to the cold water pipe.**
 - ▶ Connecting the hose to the hot water pipe may cause damage to the filter or breakdown of the product.
 - ▶ Refer to How to Install the Product (Page 12) for how to connect the tube.





How To Install the Product

How To Install the Product

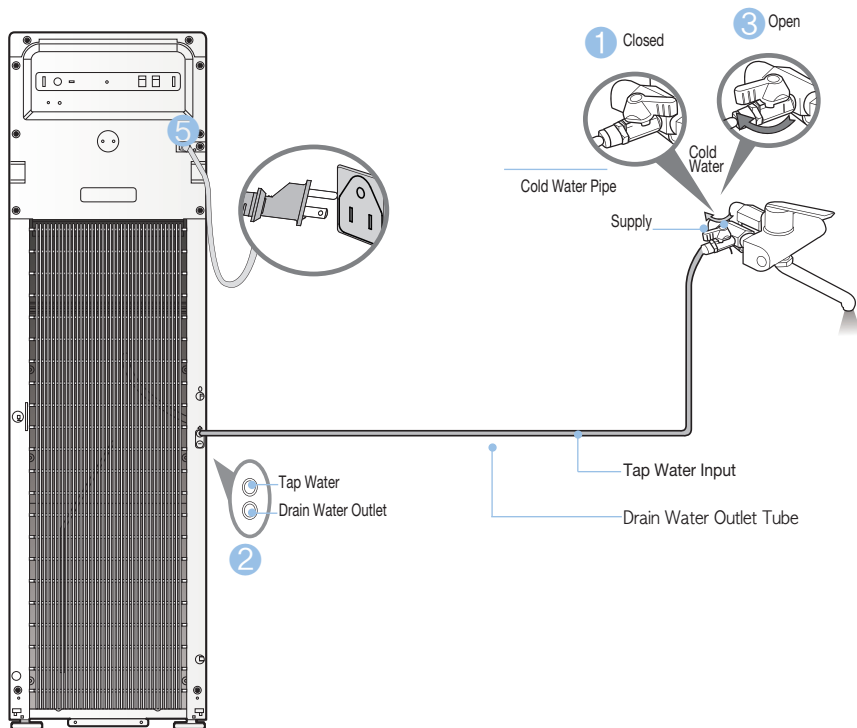

1 Close the cold water supply:

- Turn the shut-off valve located under your sink clockwise.

2 Release pressure:

- Once the cold water supply is closed and there is no flow to the faucet, open the flow of cold water from the sink faucet (lift faucet as if to run cold water) to release any pressure.

3 Disconnect feedline from under sink to the sink faucet:

- Spin the riser nut from the existing cold water shut-off. This disconnects the water feedline from the faucet.

4 Attach T-Valve to water inlet feedline:

- With the water inlet shut off valve remaining closed, screw the T-Valve (from Install Kit) onto the cold water inlet feed.

How To Install the Product



- 5 Connect the sink feed line to T-Valve:**
 - Connect the nut (from the sink faucet feed line) to the open end of the T-Valve and tighten. Make sure the connection between the T-Valve and sink feed line is secure.
- 6 Connect 1/4" Water Line:**
 - Locate the "tap water inlet" on the water filtration unit and insert the 1/4" tubing (from install kit), connect the other end of the 1/4" tubing to the T-Valve quick connect connection. Make sure both connections are secure.
- 7 Reverse Osmosis Drain Line and Saddle Valve:**
 - Reverse osmosis filters require a drain line be connected from the RO membrane to a drain pipe. Locate a horizontal or vertical section of drain pipe (wastewater from the sink) under the sink before the p-trap and away from the garbage disposal. The saddle valve is installed to hold this drain line connection firmly onto the drain pipe.
- 8 Saddle Valve:**
 - Place the saddle valve (from install kit) in the selected location of drain pipe. Mark the area where the saddle valve has its 1/4" opening on the drain pipe.
- 9 Drill Drain Line:**
 - Drill a 1/4" hole through the marked area that represented the opening of the saddle valve. Only drill through one side of the drain pipe, do NOT drill all the way through the other side of pipe.
- 10 Line up Saddle Valve:**
 - Arrange the saddle valve onto the drain pipe so that the 1/4" hole you drilled matches up with the 1/4" hole in the saddle valve. Use a bit of the water line tubing or a drill bit to ensure the holes are aligned.
- 11 Secure Saddle Valve:**
 - With the holes still aligned, secure the saddle valve clamps in place. Make sure the hole are still aligned before tightly securing the saddle valve nuts.
- 12 Connect Drain Line:**
 - Secure the second 1/4" water line in the saddle valve opening (to the drain line) on one end, to the external output of the water cooler on the other end. Make sure the connections are secure. The drain line (from water unit) should be fully into the drain pipe and secure.
- 13 Double check all connections:**
 - Check all water line connections to ensure they are secure
- 14 Turn on Cold water:**
 - Reopen the cold water inlet valve by turning counter clockwise. This will allow water flow through the attached water line, into filters and to the water unit.
CHECK THERE ARE NO LEAKS
- 15 Flush Filters:**
 - Allow the water tanks to fill completely and empty the contents to flush the unit. Complete this process Three times. The water level indicators will illuminate brightly when tank is full.
- 16 Turn on Hot/Cold Function**
 - After flushing the filters and unit, allow the hot and cold water tanks to fill completely. Once full, you may turn on the hot and cold buttons on the unit to heat and cool the purified water.
*It is very important to allow the tanks to fill completely before turning the hot/cold on.



Details to Check before Use

Caution

Do not turn on the "Cold" & "Hot" buttons without water in the tank.
(It may cause malfunction of the product.)

- Turn on the "Cold" & "Hot" buttons after filling the tank with water up to the limit.
- If you press the power button without water in the tank, the safety feature will activate, so the hot water heater will not be heated. This will cause lukewarm water to flow. Then, visit CUCKOO website for more information.
- Frequently check if the water supply is cut off and if the tap water supply valve is closed. Do not turn on the "Cold" & "Hot" buttons without water in the tank.

Details to Check before Use

1 Open the tap water supply valve.

- ▶ First, open the tap water supply valve to check if the water supply is cut off, and then open the tap water supply valve.

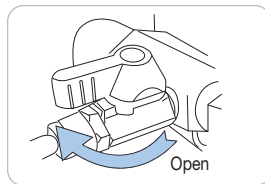

2 Connect the power supply.

- ▶ The product is exclusively use for 110V-120V 50-60 Hz. Connect it to the exclusive power outlet.
- ▶ After checking if the water supply is cut off, connect to the power supply.
- ▶ Before connecting the power, check if the "Cold" & "Hot" buttons are turned off.

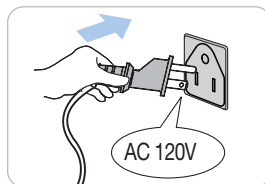

3 Press the "Hot" / "Cold" buttons to turn them on.

- ▶ If you want to use hot water, press the "Hot" button. And, if you want to use cold water, press the "Cold" button. Then the related indicator will get turned on.
- ▶ Purified water will be supplied, unless you press any button.

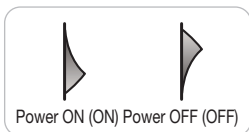
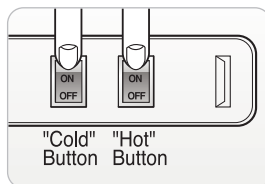

4 After long discontinued use or upon installation, completely drain out the tank. Fill it with water and drain it again before use.



Details to Check before Use/How To Use



Details to Check before Use

- 5 Empty the tray on a regular basis.

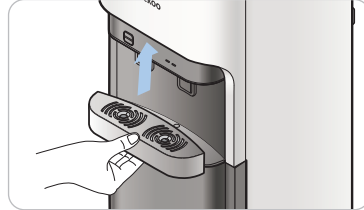

- 6 Replace and clean the filters regularly.

- ▶ You need to regularly replace the filters to ensure clean water.
- ▶ Refer to Page 23 for the filter replacement cycle.

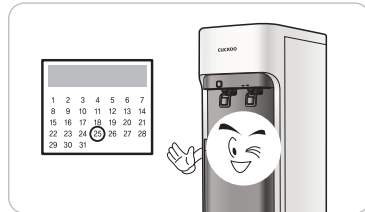

How to Get Hot Water

- 1 Press the “Hot” button to turn it on. It takes about 30 minutes for the heater to heat the water.

- ▶ Before turning on the “Hot” button, make sure the water supply is available and the tap water supply valve is open.

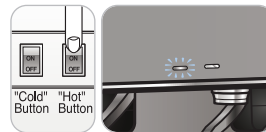

- 2 Gently push the hot water lever and then press the Child Lock button.

Do not press the hot water lever while pressing the Child Lock button. Doing so may create a splash and potential burn.



- 3 Lift the hot water lever up at a 90° angle and press the Child Lock button for a continuous extraction of hot water.

After the discharge of hot water, slowly return the lever to its original position. (If this is done too quickly, you may be burnt by splashing hot water)



The first glass may be lukewarm. This is due to the outflow of cold water and hot water through the same pipe. After the first glass, hot water will be extracted at a normal temperature.



How to Use

How to Get Cold Water

- 1 Press the “Cold” button to turn it on. It takes 60 minutes for the cooler (condenser) to cool the water.

▶ Before turning on the “Cold” button, make sure the water supply is available and the tap water supply valve is open.

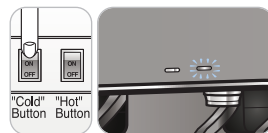

- 2 Gently push the cold water lever.



- 3 Lift the cold water lever up at a 90° angle, Then continuous extraction of cold water is available.

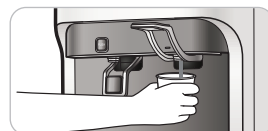

The first glass may be lukewarm. This is due to the outflow of cold water and hot water through the same pipe. After the first glass, cold water will be extracted at a normal temperature.

How to Clean the Cold Water Tank



How to Clean the Cold Water Tank

- 1 First close the tap water supply valve.

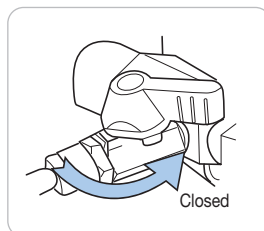

- 2 Press the "Hot" / "Cold" button to turn it off.

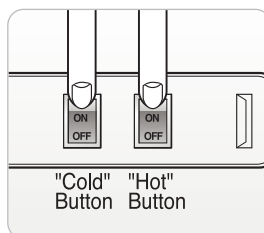

- 3 Unplug the power plug for safety.

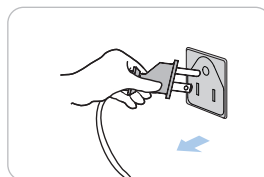

- 4 Drain the cold water tank through the cold water faucet.

- ▶ Drain water into a clean bowl as it will be used to clean the tank.
- ▶ Approximately 6.8L of water will be drained, so use a bowl in an appropriate size.



- 5 Connect the hot water drain tube to the hot water faucet and the hot water drain in order to drain out all the hot water from the hot water tank.

- ▶ Beware as the hot water is very hot.
- ▶ About 4.0 L of water will come out, so prepare a bucket of a sufficient size.
- ▶ If you drain hot water before draining cold water, about 10.8 L of water will come out. Drain cold water before draining hot water. (After hot water is completely drained, close the stopper of the Hot Water Drain.)

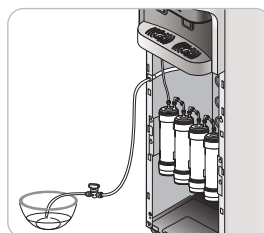



How to Clean the Cold Water Tank

How to Clean the Cold Water Tank

6 Remove the lid cover of the product.

- ▶ Requires a phillips head “+” screwdriver.

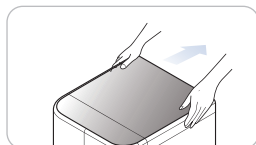
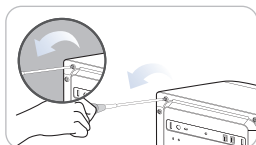

7 Remove the cover from the cold water tank.

- ▶ The upper part of cold water tank is slightly warm because it contains ambient water and hot water steam.

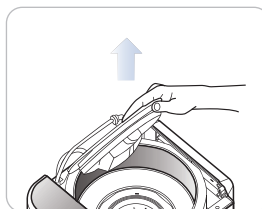

8 Remove separator from the cold water tank by pulling the separator.

- ▶ When you remove the separator and clean the inside of the tank, please wear gloves to ensure it is properly sanitized.

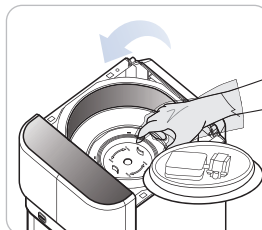

9 Wipe out the inside of the tank with a clean and soft cloth.

- ▶ Make sure no foreign substances are left inside the tank.

Scale may form inside the tank due to minerals melted in the water. When you use the water purifier infrequently, drain water through the cold / hot water faucet once every two to three days. Then you can prevent scale from forming. (It is best to use the purified water within a short period of time.)

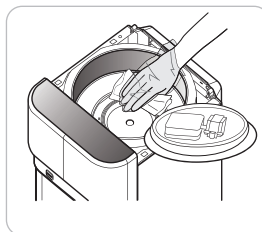

10 Pour the drained water (refer to Step. 4) into the tank and wash it.

- ▶ Completely drain the used water through the cold water faucet.
- ▶ Remove the hot water drain ball valve (end cap) and completely drain the water that flowed into the hot water tank. Then close the cap.



How to Clean the Cold Water Tank



How to Clean the Cold Water Tank

11 Reassemble the separator to the cold water tank.

- ▶ Cautiously press the separator into place.

If it is not placed properly, the operation of the compressor will be effected, which can cause noise. Please make sure place the separator properly.

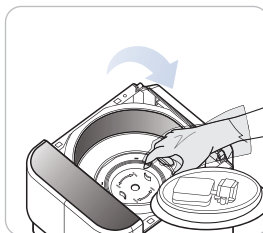

12 Please install the cover on the cold water tank.

- ▶ Make sure the cover of cold water tank is completely closed.

Otherwise, foreign substances may enter into the tank.

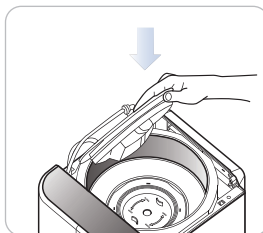

13 Place the lid cover on the product and fasten it with screws. Open the tap water supply valve and check whether water flows from the hot/cold water faucets.

- ▶ Tighten the screw with a phillips head '+' screwdriver.

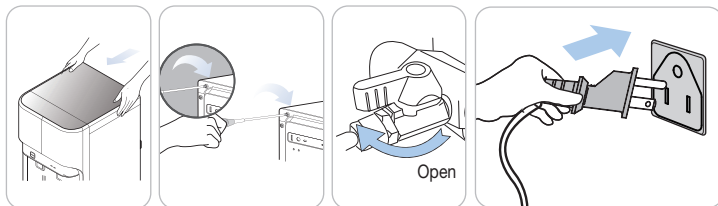

14 Plug power plug and press the "Cold" / "Hot" buttons to turn them on.



- ▶ After checking water flow through the hot water faucet, turn on the "Hot" buttons.

※ Clean the tank on a regular basis in order to drink clean and healthy water.



How to Clean Tray

How to Clean Tray

1 Separation of Tray

- ▶ Hold and move the tray upwards to separate the tray.



2 Separation of Tray Cover

- ▶ After removing the tray, pull from the hole of the cover on the top of the tray to separate the tray cover.



3 Cleaning of Tray

- ▶ Throw away the stagnant water in the tray, and remove the remaining with a soft cloth, etc.

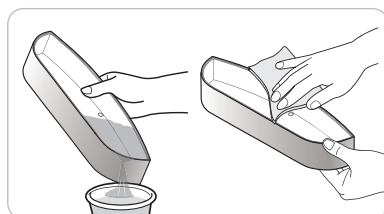

4 Assembly of Tray

- ▶ After finishing the cleaning of the tray, assemble it in the reverse order of dismantling.

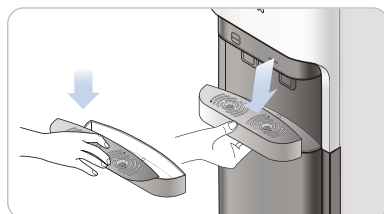

How To Replace the Filter



How to Replace the Filter (CUCKOO Filter (genuine) must be used)

- 1 Close the tap water supply valve.

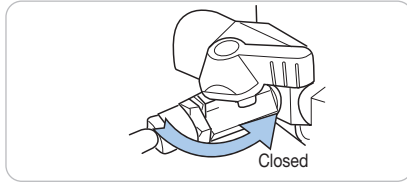

- 2 Remove the remaining pressure inside the pipe.
▶ Drain approximately 3~4 cups (500cc) of water from the cold water faucet.



- 3 Turn off the "Hot" / "Cold" buttons, and unplug the product.

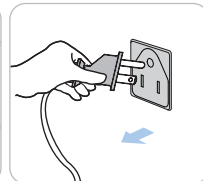
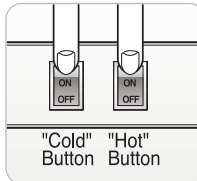

- 4 Drain out all the water remaining in the purifier.

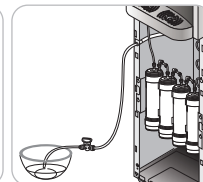

- 5 For the Half Type, remove the right side cover for filter replacement.

▶ Requires a phillips head "+" screwdriver.

※ When removing screws, please make water purifier fully drained before leaning it. Leaning it with residual water inside may cause spillover.

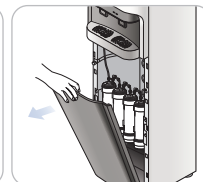
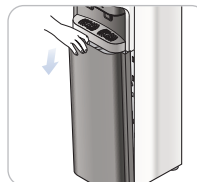
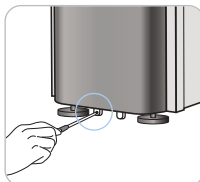



How To Replace the Filter

How to Replace the Filter (CUCKOO Filter (genuine) must be used)

6 Before replacing the filter, detach the connecting tube of the filter you wish to replace.

- ▶ Detach the connecting tube using an appropriate tool (fitting separator). Damage to the fitting and/or connecting tube may cause water leak.



7 Connect the outlet of the previous filter to the inlet of the replaced filter and connect a separate water extraction tube to the outlet of the replaced filter. Then, open the tap water supply valve to allow water to pass through.

- ▶ Especially for the SEDIMENT, allow water to pass through for about 5 minutes.
- ▶ Connect PRE CARBON 2.0 NATURAL 2.0 to the previous filters, and allow water to pass through for about 7 minutes.
- ▶ Connect the RO to the previous filters, and allow water to pass through for about 10 minutes.
 - ※ In case of RO, let the water pass through the external drain water control valve.
 - ※ In case of RO, be careful as there are two water outlet each for purified water and drain water.
- ▶ Allow plenty of water to pass through or else it will affect the taste and quality of water.
- ▶ It is important to supply the purifier with water to check for any water leaks after filter replacement.

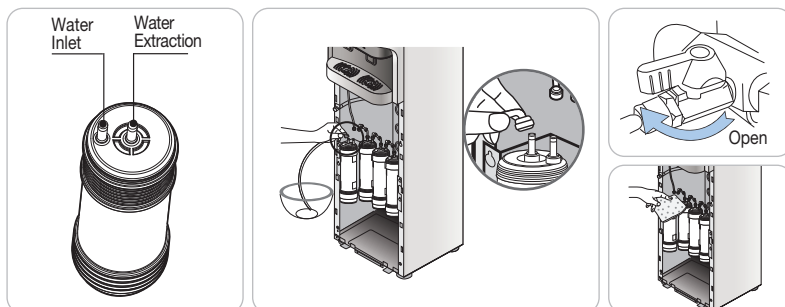

How To Replace the Filter



How to Replace the Filter (CUCKOO Filter (genuine) must be used)

- 8 (Stand Type)** Place the lower front cover again and fasten it with screws.
- ▶ Find the accurate place of the screws to ensure the cover to be fastened properly.
 - ▶ Requires a phillips head “+” screwdriver.

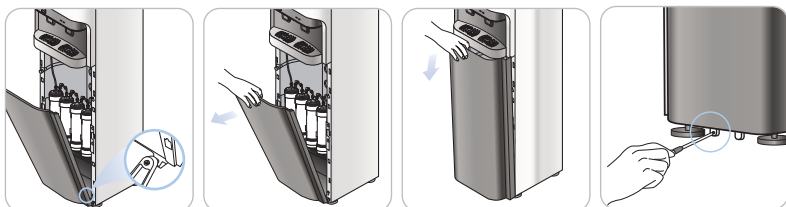

- 9** Turn on the tap water supply valve and fill the tank with water up to the limit then drain it out. Repeat twice.

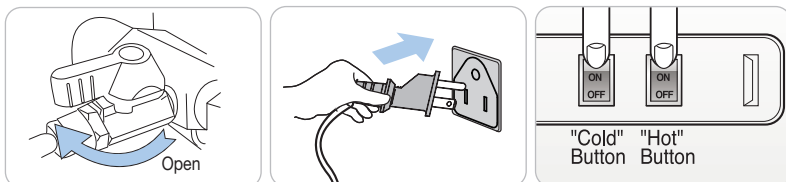

- 10** After filling the tank with water, connect the power plug.





Expected Filter Replacement Cycle / Recommendations/Filter Arrangement

Recommended Filter Replacement Cycle

- ▶ The filter replacement cycle is determined with the use of 10 L, and may be affected by the condition of tap water.

Model	Filter Name	Expected Filter Replacement Cycle
CP-DRP1201SW	Sediment	1800L / 6 months
	Sediment 3.0 (optional)	1800~2400L / 6~8 months
	Precarbon 2.0	1800L / 12 months
	RO membrane	3600~5400L / 24months
	Natural 2.0	3600L / 12 months
	Mineralizer (optional)	3600L / 12 months

※ Note: the above replacement cycles are estimates only and may vary depending on feedwater condition.

Recommendations

- ▶ **Filtration Capacity**
Filtration capacity is the recommended amount of usage by the rate of removal of chloroform etc. This is to get the life span of of the filters in the purifier.
- ▶ **Filter Replacement Cycle**
The filter replacement cycle means the expected cycle (period) that the filters can perform properly.
The filter replacement cycle may vary based on usage. Its standard cycle has been set under condition that the supply is tap water with about 10L (drinking water (for four people) used per day).
- ▶ In the reverse osmosis membrane filter system, the water purified through the filter is 20~35% of the raw water (Water temperature 25°C, Water Pressure 0.34 MPa). This can vary depending on water temperature and water pressure.

Filter Arrangement

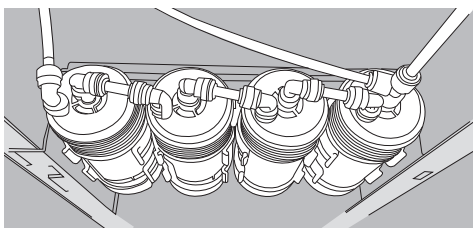
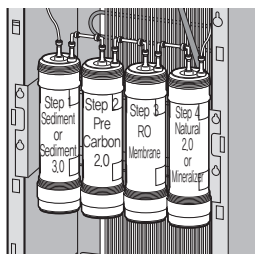

- ▶ When each filter is connected to fitting hose, filters' label should be facing to the right side for 10mm.

How to install the Overturning prevention wire



How to install the Overturning prevention wire

To prevent overturning of the water purifier, make sure to attach the overturning prevention wire on the wall. Please attach to the wall when wire and pin are expanded.

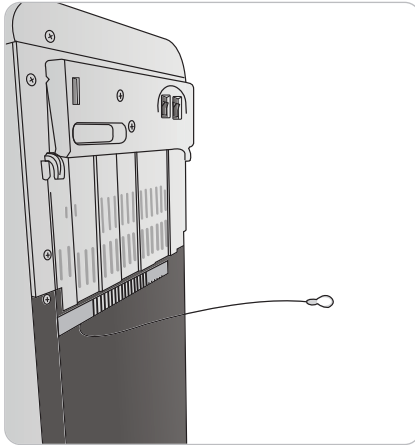

Please check before asking for support

- ▼ When the Water Purifier is not used properly, in compliance with the User Manual, the product may operate abnormally even if it is not broken down. In such case, please take the following instructions accordingly. If you cannot solve the problem, please contact Cuckoo website.

Problem	Checklist	Recommendation
The water has an unpleasant taste or odor.	<ul style="list-style-type: none"> • Have you not used the Water Purifier for a long time? • Is it time to replace the filter(s)? • Have you not used hot water for a long time? 	<ul style="list-style-type: none"> • Drain the water from the hot/cold water tanks and clean the cold water tank. • Replace the filter (with a genuine filter of Cuckoo). • Drain the water from the hot water tank through the hot water drain tube from the back. Discharge hot water through the hot water faucet frequently.
There is no water coming out.	<ul style="list-style-type: none"> • Is the tap water connected properly? • Is your household water pressure low? • Are you getting cold water but not hot water? • Do you think there is a problem with the hot/cold water lever? 	<ul style="list-style-type: none"> • Open the tap water supply valve. • Check if the feed tube is bent. • Check if the water supply is cut off. • Attaching External Pump (Optional) / Contact Customer service. • Push the hot water lever as you press the Child Lock button. • Check whether the hot water indicator is on. • Check if the power is on. • ※ If you still don't get any hot water after checking the above, please contact our customer service. • Contact Cuckoo website.
The hot water temperature is too low.	<ul style="list-style-type: none"> • Is the hot water indicator on? • Did you already extract a lot of hot water? • Is the temperature of purified water at room temperature? 	<ul style="list-style-type: none"> • Turn the "Hot" button "ON" and make sure the hot water indicator is on. • If you extracted all of the hot water from the hot water tank, you need to wait 30 minutes to re-heat the water. • Turn the "Hot" button "OFF" and contact Customer Service.

Please check before asking for support

▼ When the Water Purifier is not used properly, in compliance with the User Manual, the product may operate abnormally even if it is not broken down. In such case, please take the following instructions accordingly. If you cannot solve the problem, please contact Cuckoo website.

Problem	Checklist	Recommendation
The cold water temperature is too high.	<ul style="list-style-type: none"> • Is the cold water indicator on? • Did you already use a lot of cold water? • Is the back of the product properly ventilated? 	<ul style="list-style-type: none"> • Turn the "Cold" button "ON" and make sure the cold water indicator is on. • If you used all the cold water in the cold water tank, you need to wait approximately 1 hour to re-cool the water. • Check if the radiator at the back of the product is blocked. Remove any objects blocking the radiator. • Move the product to a well-ventilated area. (contact customer service before moving and re-installing the product)
There is a sudden decrease in the amount of purified water.	<ul style="list-style-type: none"> • Did you close the tap water supply valve? • Is it time to replace the filter? 	<ul style="list-style-type: none"> • Open the tap water supply valve. • Replace the filter with Cuckoo Filter (genuine).
There is a loud noise coming from the purifier.	<ul style="list-style-type: none"> • Did you place the product on a flat area? • Is it in contact with other products/products? • Does it happen when you extract water from the faucet? • Does it get noisy after the pump operation? 	<ul style="list-style-type: none"> • Place the product on an even and sturdy area. • Make sure the product is not in contact with other product. • Because the water purifier is directly connected to tap water, the water immediately flows when water is extracted. The noise is caused by the water flow which is normal. • It is the pump working in order to supply purified water to the tank, which is a normal operation after water extraction.
There are floating substances in the water.	<ul style="list-style-type: none"> • Is it time to replace the filter? 	<ul style="list-style-type: none"> • Replace the filter with Cuckoo Filter (genuine).
Water is leaking from the purifier.	<ul style="list-style-type: none"> • Is the assembled (connecting) part defective? • Is your home or external environment humid? 	<ul style="list-style-type: none"> • After closing the tap water supply valve, unplugging the product and contact Cuckoo website. • When moisture in the air comes in contact with the cold part of the purifier, it'll condense on the purifier like dew. A similar phenomenon can be seen with water droplets forming on glass.

Product Specification

Product Name		Drinking Water Coolers
Types		Stand Type
Model		CP-DRP1201SW
Rated Voltage		AC 120V / 60Hz
Power Consumption		Hot : 465W(3.9A) / Cold : 120W(1.9A) / TOTAL : 585W(5.8A)
Purification Method		Reverse Osmosis Filtration System
Filter Types		SEDIMENT / SEDIMENT 3.0
		PRE CARBON 2.0
		RO MEMBRANE
		NATURAL 2.0 / MINERALIZER
Capacity	Purified Water	4.3L
	Cold Water	2.5 L
	Hot Water	4.0L
	Total Capacity	10.8 L
Types of Refrigerants		R-134a, 1.55oz
The high and low-side design pressure		High-side : 186psig, Low-side : 88psig
Climate Class		N (Temperate)
Installation Area		For indoors
Total Capacity		62.8lb
Size (WxDxH)		360(W) X 427(D) 1269(H)mm
Normal Operation Pressure		0.07~0.7MPa(0.7~7.0 bar)

※ The details indicated in this User Manual (exterior, design, and specifications) may be changed without previous notice for improvement of quality of the product.





MEMO





MEMO



CUCKOO

www.cuckooworld.com

CUCKOO ELECTRONICS AMERICA INC

Z0306-0799E0 Rev.0